

5KEK1222



KitchenAid

English	5
Deutsch	14
Français	21
Italiano	29
Nederlands	37
Español	45
Português	53
Ελληνικά	61
Svenska	69
Norsk	77
Suomi	85
Dansk	93
Íslenska	101
Русский	109
Polski	117
Český	125
العربية	133



TABLE OF CONTENTS

ELECTRIC KETTLE SAFETY

Important safeguards	6
Electrical requirements	8

PARTS AND FEATURES

Parts.....	9
------------	---

OPERATING THE ELECTRIC KETTLE

Before first use	10
Heating water	11

CARE AND CLEANING

Cleaning the exterior.....	11
Cleaning the filter	11
Removing mineral deposits from the interior.....	12

WARRANTY AND SERVICE.....	13
---------------------------	----

ELECTRIC KETTLE SAFETY

Your safety and the safety of others are very important.

We have provided many important safety messages in this manual and on your appliance. Always read and obey all safety messages.



This is the safety alert symbol.

This symbol alerts you to potential hazards that can kill or hurt you and others.

All safety messages will follow the safety alert symbol and either the word "DANGER" or "WARNING." These words mean:

! DANGER

You can be killed or seriously injured if you don't immediately follow instructions.

! WARNING

You can be killed or seriously injured if you don't follow instructions.

All safety messages will tell you what the potential hazard is, tell you how to reduce the chance of injury, and tell you what can happen if the instructions are not followed.

IMPORTANT SAFEGUARDS

When using electrical appliances, basic safety precautions should always be followed, including the following:

1. Read all instructions.
2. Warning: Misuse may cause potential injury.
3. Do not touch hot surfaces. Use handles.
4. To protect against fire, electrical shock and injury to persons do not immerse base, cord, plug, or Electric Kettle in water or other liquids.
5. Warning: Avoid spillage on the connector.
6. This appliance can be used by children aged from 8 years and above if they have been given supervision or instruction concerning use of the appliance in a safe way and if they understand the hazards involved. Cleaning and user maintenance shall not be made by children unless they are older than 8 and supervised. Keep the appliance and its cord out of reach of children aged less than 8 years.
Appliances can be used by persons with reduced physical, sensory or mental capabilities or lack of experience and knowledge if they have been given supervision or instruction concerning use of the appliance in a safe way and understand the hazards involved.
7. The heating element surface is subject to residual heat after use. Unplug Electric Kettle from outlet and allow to cool before cleaning or removing parts.
8. Do not operate Electric Kettle with a damaged cord, plug, or other malfunction. If the supply cord is damaged, it must be replaced by the manufacturer, its service agent or similarly qualified persons in order to avoid a hazard. See “Warranty and Service Information.”
9. The Electric Kettle is only to be used with the base provided. Use of replacement parts not recommended by manufacturer may result in fire, shock, or injury to persons.
10. Do not use outdoors.
11. Do not let cord hang over counter or table edges, or allow to come into contact with heated surfaces.
12. Do not use near or on a hot gas or electric burner stove.

SAVE THESE INSTRUCTIONS

- 13.** The Electric Kettle should only be used to heat water.
- 14.** Do not use the Electric Kettle without lid properly closed.
- 15.** Do not use the Electric Kettle with a loose or weakened handle.
- 16.** Do not use the appliance for other than intended use.
- 17.** Do not clean Electric Kettle with abrasive cleaners, steel wool, or other abrasive materials.
- 18.** This appliance is intended to be used in household and similar applications such as:
 - staff kitchen areas in shops, offices and other working environments;
 - farm houses;
 - by clients in hotels, motels and other residential type environments;
 - bed and breakfast type environments.Not designed for commercial use.
- 19.** Do not overfill Electric Kettle. If the Electric Kettle is overfilled, boiling water may be ejected.

ELECTRIC KETTLE SAFETY

Electrical requirements

⚠️ WARNING



Electrical Shock Hazard

Plug into a grounded outlet.

Do not remove ground prong.

Do not use an adapter.

Do not use an extension cord.

Failure to follow these instructions can result in death, fire, or electrical shock.

Volts: 220–240 V.A.C.

Hertz: 50/60 Hz

Watts: 1850–2200

NOTE: The Water Kettle has a grounded plug. To reduce the risk of electrical shock, this plug will fit in an outlet only one way. If the plug does not fit in the outlet, contact a qualified electrician. Do not modify the plug in any way.

Do not use an extension cord. If the power supply cord is too short, have a qualified electrician or serviceman install an outlet near the appliance.

A short power supply cord (or detachable power supply cord) should be used to reduce the risk resulting from becoming entangled in or tripping over a longer cord.

Electrical equipment waste disposal

Disposal of packing material

The packing material is 100% recyclable and is marked with the recycle symbol . The various parts of the packing must therefore be disposed of responsibly and in full compliance with local authority regulations governing waste disposal.

Scrapping the product

- This appliance is marked in compliance with European Directive 2002/96/EC, Waste Electrical and Electronic Equipment (WEEE).
- By ensuring this product is disposed of correctly, you will help prevent potential negative consequences for the environment and human health, which could otherwise be caused by inappropriate waste handling of this product.

- The symbol  on the product or on the accompanying documentation indicates that it should not be treated as domestic waste but must be taken to an appropriate collection centre for the recycling of electrical and electronic equipment.

For more detailed information about treatment, recovery and recycling of this product, please contact your local city office, your household waste disposal service or the shop where you purchased the product.

PARTS AND FEATURES

Parts

English

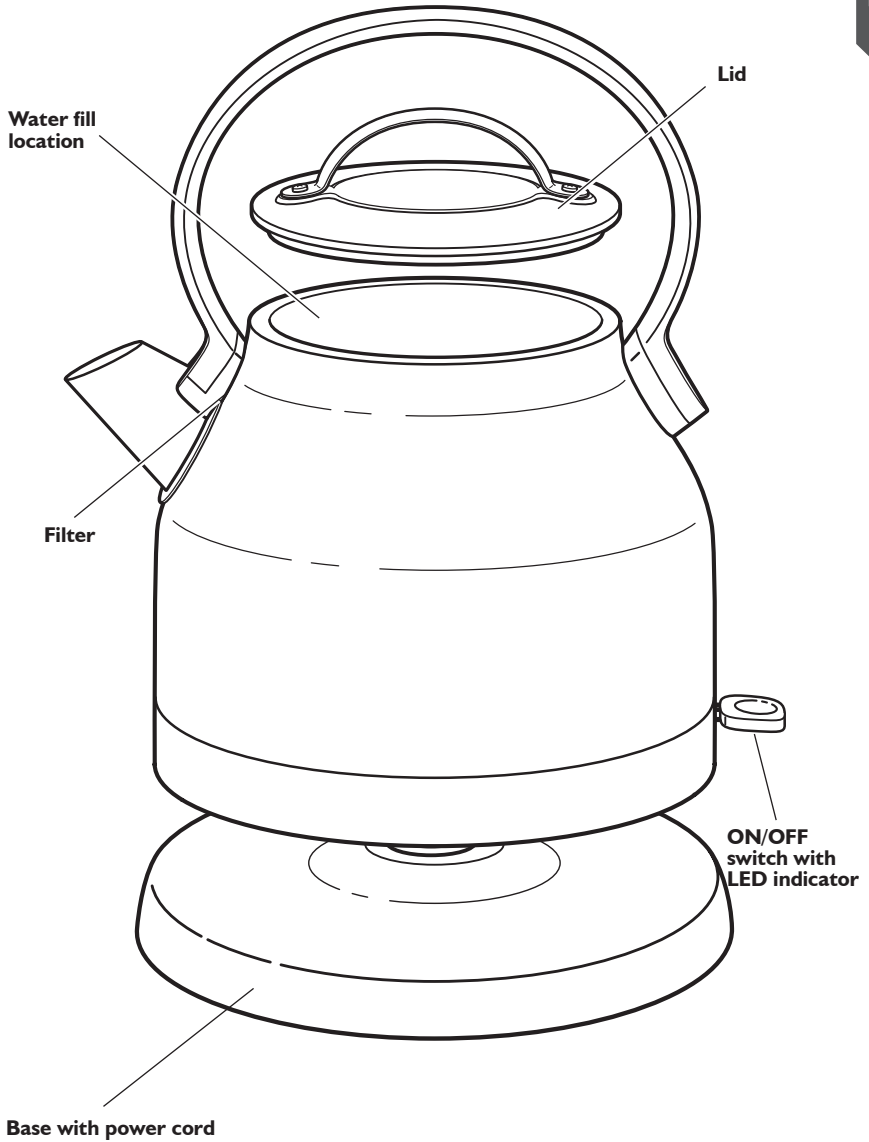

OPERATING THE ELECTRIC KETTLE

Before first use

Before first use, fill the Electric Kettle to the maximum level, then boil and discard the water.

NOTE: The Electric Kettle is designed for water only. Do not put any other liquids or substances in the Electric Kettle.

Heating water

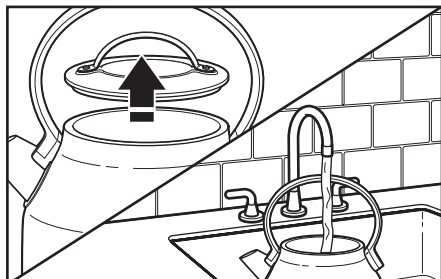

1 Remove the lid from the kettle. Fill the electric kettle with water.

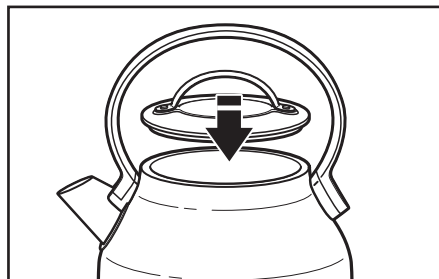

2 Replace the lid.

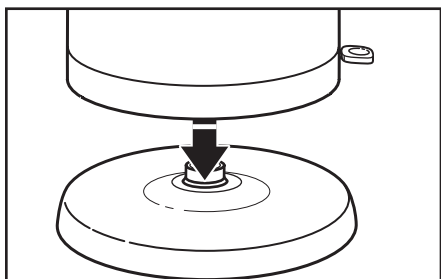

3 Place the electric kettle on the base.

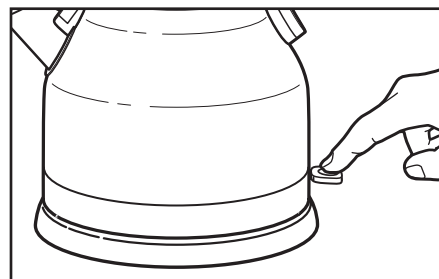

4 Turn the electric kettle ON by pressing the ON/OFF switch down. The LED indicator will light.

Kettle will automatically turn OFF when water has finished boiling.

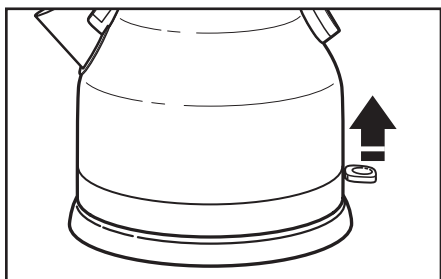

5 You may also turn it off by raising the switch to the OFF position.

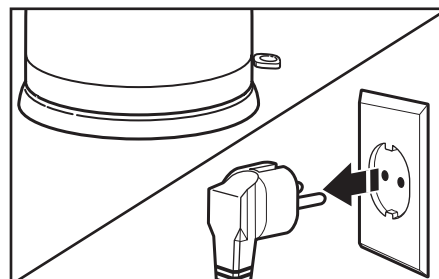

6 Unplug cord when Electric Kettle is not in use.

CARE AND CLEANING

Cleaning the exterior

IMPORTANT: Before cleaning always disconnect the Electric Kettle from electrical outlet. Make sure the Electric Kettle has cooled completely.

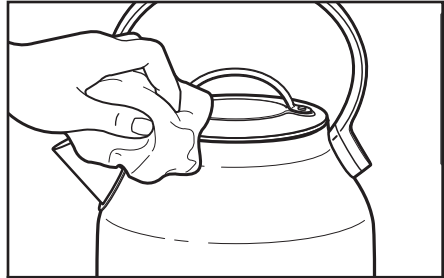

1 The exterior of the Electric Kettle may be cleaned with a damp cloth. Dry and polish the Electric Kettle with a soft cloth. Abrasives and scouring agents of any kind are not recommended.

English

Cleaning the filter

The Electric Kettle features a removable mesh filter that traps scale deposits for cleaner water. The filter will need to be cleaned periodically—more often if you have hard water.

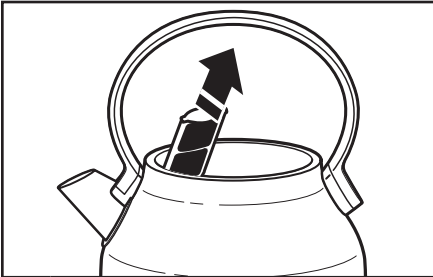

1 To access filter: Open the lid; the filter is located behind spout inside Electric Kettle. Grasp the top of the filter to remove.

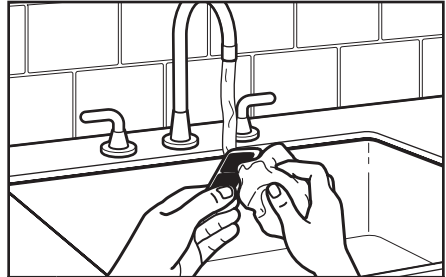

2 Clean under hot water with a soft brush or cloth to remove deposits, and replace filter by sliding the filter into the slot behind the spout.

NOTE: If calcium deposits remain on the filter, let it stand overnight in a solution of water and white vinegar. Rinse the filter thoroughly and replace in the Electric Kettle.

CARE AND CLEANING

Removing mineral deposits from the interior

To get the best performance from your Electric Kettle, decalcification will be necessary. Calcium deposits may form on the interior metal parts of the Electric Kettle. The cleaning interval will depend on the hardness of the water you put in the Electric Kettle.

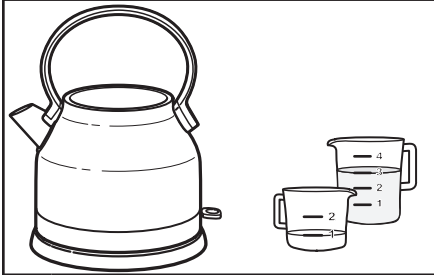

1 Fill the Electric Kettle with 1 cup (.25 L) white vinegar. Add 3 cups (.75 L) water. Turn kettle ON.

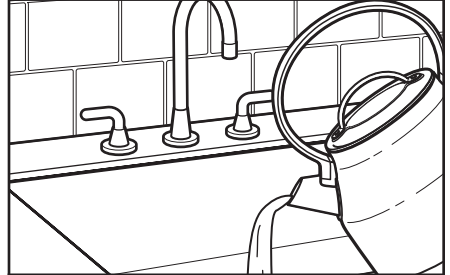

2 Empty solution from Electric Kettle and repeat process twice. Electric Kettle is now ready for use.

WARRANTY AND SERVICE

KitchenAid Kettle warranty

Length of Warranty:	KitchenAid Will Pay For:	KitchenAid Will Not Pay For:
Europe, Middle East and Africa: For model 5KEK1222: Two years full warranty from date of purchase.	The replacement parts and repair labor costs to correct defects in materials or workmanship. Service must be provided by an Authorized KitchenAid Service Center.	A. Repairs when Kettle is used for operations other than normal household food preparation. B. Damage resulting from accident, alterations, misuse, abuse, or installation/operation not in accordance with local electrical codes.

English

KITCHENAID DOES NOT ASSUME ANY RESPONSIBILITY FOR INDIRECT DAMAGES.

Customer service

In U.K. and Ireland:

For any questions, or to find the nearest KitchenAid Authorized Service Center, please find our contact details below.

NOTE: All service should be handled locally by an Authorized KitchenAid Service Center.

Contact number for U.K. and Northern Ireland:

Tollfree number 0800 988 1266 (calls from mobile phones are charged standard network rate) or 0194 260 5504

Contact number for Ireland:

Tollfree number +44 (0) 20 8616 5148

E-mail contact for U.K. and Ireland:

Go to www.kitchenaid.co.uk, and click on the link "Contact Us" at the bottom of the page.

Address for U.K. and Ireland:

KitchenAid Europa, Inc.
PO BOX 19
B-2018 ANTWERP 11
BELGIUM

In other countries:

For all product related questions and after sales matters, please contact your dealer to obtain the name of the nearest Authorized KitchenAid Service/Customer Center.

www.KitchenAid.eu