

# 145x210mm 2019-9-18 CCZ

# linsar

Model:BH-607

## Handheld Vacuum Cleaner

### Instruction Manual

### Contents

Product Introduction

Product Operation

Product Maintenance

Trouble Shooting

Safety Introduction

Warranty Information

2

- Before charging, please check the power adapter and socket is firmly connected.
- When the dust bin is full, empty the contents before using this product.
- This product is functioning at temperature range within 5℃ to 40℃.
- Do not use this product in high-temperature environment.
- Please remove batteries from this product before disposal.

#### Product Technical Information

Model	Rated Charging Voltage	Rated voltage	Rated Power
BH-607	100-240V	22.2V	120W

#### Product Introduction

- 1 Main body
- 2 Battery pack
- 3 Wall mount
- 4 Straight tube
- 5 Power brush
- 6 2 in 1 brush
- 7 Crevice tool
- 8 Power adapter

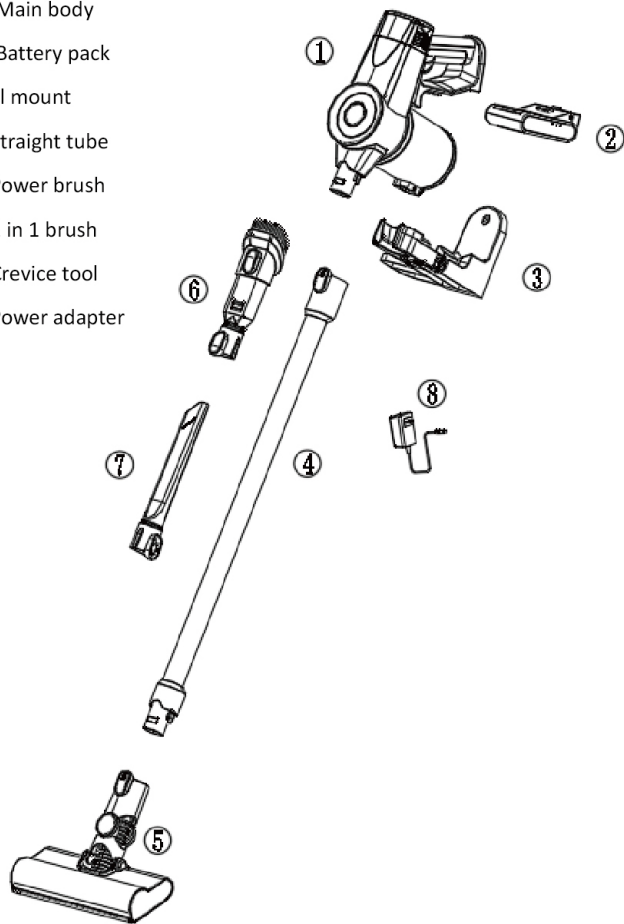

Tips: Accessories can be connected with extension tube when cleaning high position

3

#### Product Operation

##### Charging

The battery is not charged out of the box. Please be sure to fully charge the battery before use.

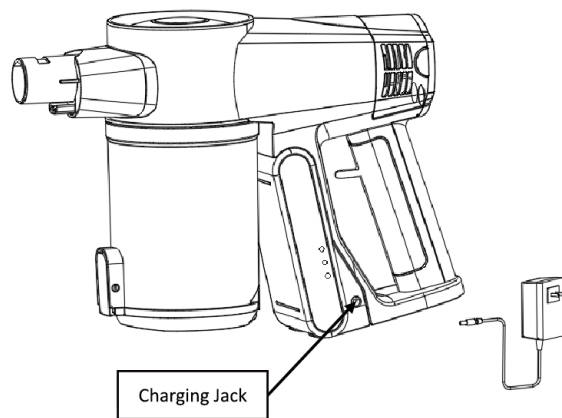

Step 1: Put the main body on a horizontal table.

Step 2: Connect the power cord to the mains outlet and the charging lead in the handle part of the main body to start charging, and the power indicator flashes. After full charge, the three indicator lights are always on.

Step 3: Charging time: 4.5 hours. Run time: standard speed 45mins.

##### Attention:

1. Do not charge at temperatures below 5℃ or above 40℃.
2. During operation, the battery indicator lights will be reduced.

4

#### Trouble Shooting

In case of malfunction, please refer to the following table

Problem	Possible reason	Solution
Electric brush doesn't work	Large objects (e.g. packaging film) caught in the brush. Brush is intertwined by hair	Clear the hair intertwined on the brush. Clear any objects.
Running time becomes shorter	Battery is aged Ambient temperature is too high or too low The battery isn't fully charged	Contact your dealer or after-sales personnel to purchase a new battery Use in appropriate environment Please charge the battery
Suction power becomes weak	Too much dust in the cup Cotton filter is blocked Brush or accessory suction port is blocked Hasn't been fully dried after washing	Empty dust canister. Wash the cotton filter. Clear the blockage. Dry the part in cool place after washing
Can't charge	Ambient temperature is too high or too low	Charge in appropriate environment (5℃-40℃)
Battery leaks	The battery is not used for a long time	Replace battery

#### Safety Introduction

- Only the certified technician should disassemble this product. Users are advised not to disassemble this product.
- This product must only be charged using the included power adapter. Other power adapters may cause damages to this product.
- Running the battery down before charging will extend the life of the battery.
- Do not touch power cord, plug or adapter with wet hands.
- Avoid curtains, any kind of strings or user's body part wrapping around the brush.
- Keep this product away from cigarette stubs and other flammable items.
- To clean the product, this product must be fully charged before any cleaning process.
- Do not over-bend the power cord, or place heavy or sharp objects on this product.
- This product is intended for indoor use only, do not use this product outdoors.
- Do not place objects with more than 10KG weight on this product.
- Do not use this product in a wet or moist environment.
- Before using this product, please remove any fragile objects from the floor. Also removes any objects that may be wrapped up to the side brushes or may block the suction inlet.
- If not using the product for long time, please ensure the charger is unplugged.

13

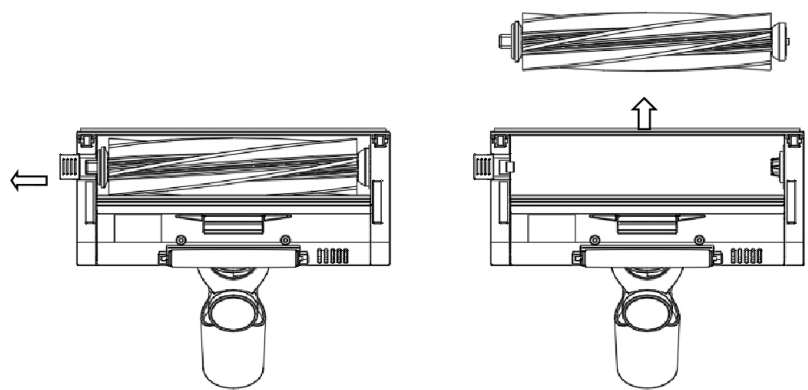

Tips: The brushroll and its cover are washable; please ensure they are completely dried before use.

##### Attention

- When the dust blocks the air flow of the floor brush, please clean it with a stick.
- Except for the brushroll and its cover, all other components can't be washed with water.
- Do not apply oil to both ends of the brushroll.
- Do not touch the working brushroll part and stay away from the air outlet when in operation.
- Do not use when wheels or scrubber's nylon loop are damaged.

12

#### Cleaning

To prevent blockage of the air passage large objects like large paper and packing materials should be removed from the area before start cleaning

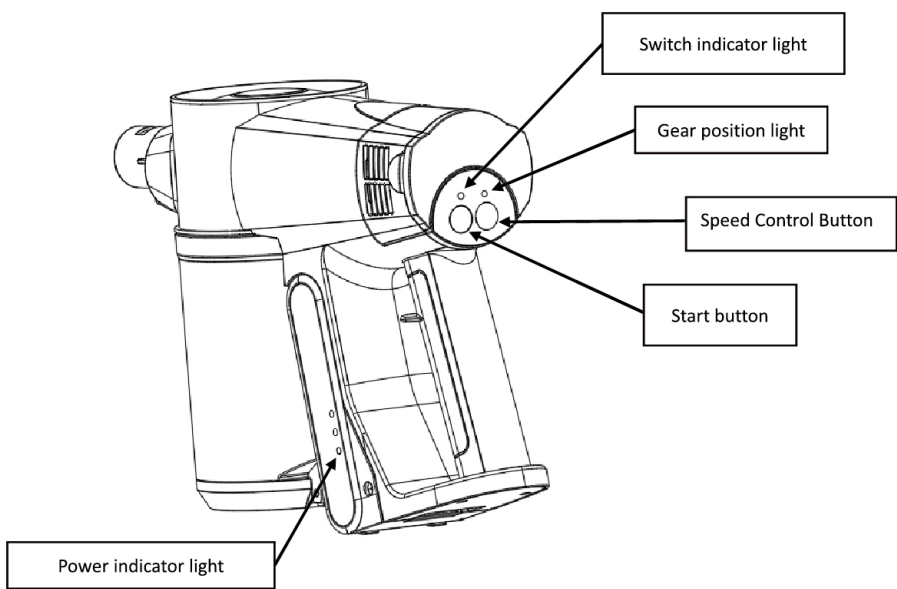

1. Press the start button to start the cleaner.
2. Press again the start button to stop cleaning.
3. Press speed control button to choose power setting. Gear position light will be on when in high speed.
4. When the machine is working, three power indicator lights are always on. This means that the battery will require charging.

#### Replacing battery

Tips: If you need to replace the battery please consult your dealer.

Important note – The rechargeable battery is a consumable product therefore, if the battery life becomes shorter and charging time becomes longer, please replace the battery.

5

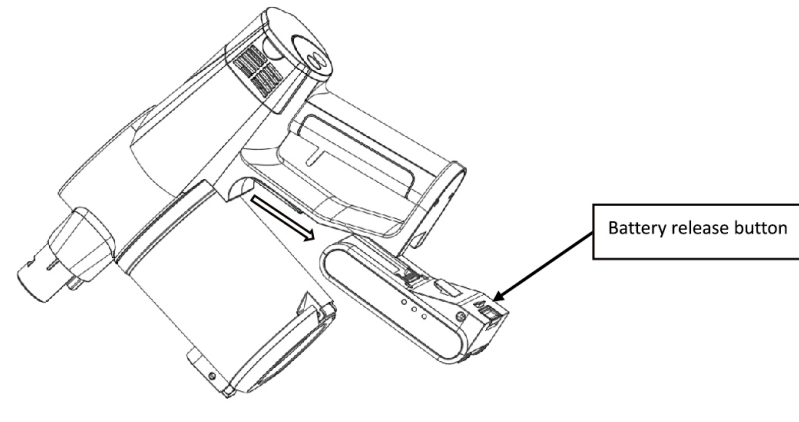

Press the battery release button, take out the battery

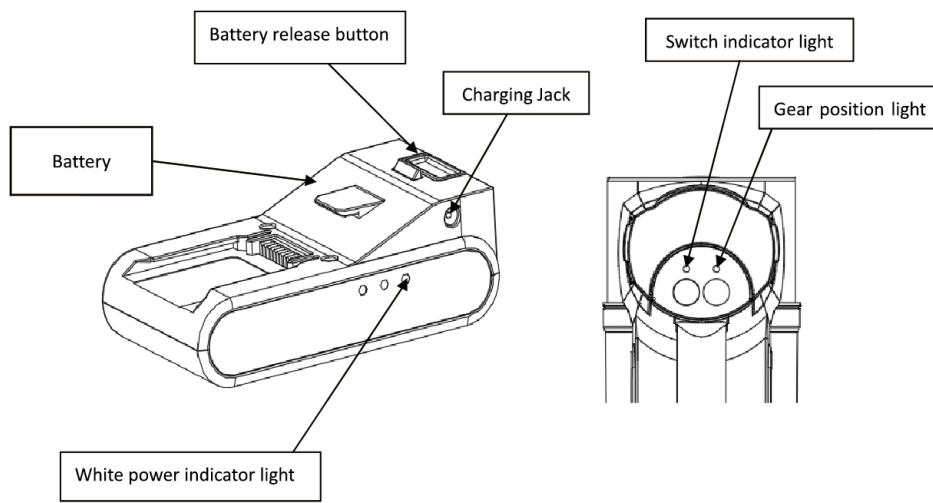

##### Indicator light description

1. Press start button, the machine starts working, the power indicator light and switch indicator light will be on. When the gear indicator light is off, it will be at the low speed. Press the speed control button to switch to high speed and the gear indicator light will be on.
2. When charging the unit, the three indicator lights are displayed like. When the charge reaches a certain level, the corresponding indicator lights will always be on, and the three indicator lights will all be on after fully charged.

6

#### Warning

1. Please pay attention to sharp objects such as glass to prevent injury.
2. The parts must be completely dry before installing.
3. Do not scrub the filter cotton or apply brute force to it
4. Please make sure that the filter cotton has been installed before assembly.
5. Do not continue to use when the filter cotton in the dust cup is damaged or if the cleaning and maintenance are not sufficient.

#### Power Brush Cleaning

Please clean the brush when the brushroll or the wheel is entangled with hair.

Step 1: Disassemble the power brush.

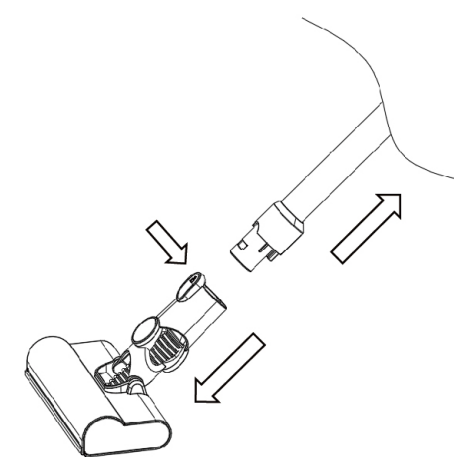

Step 2: Push the bristle brush block to the left, take out the ground brush and clean it. After all the parts are fully dried, install them back according to the above disassembly steps.

11

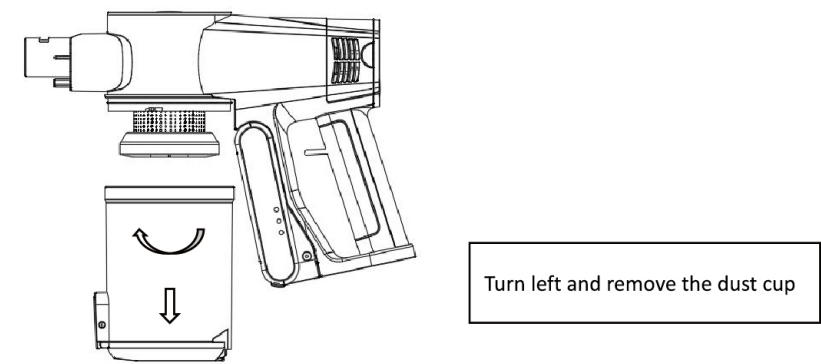

Step 3: Rotate to the left, remove the filter element and clean the filter element.

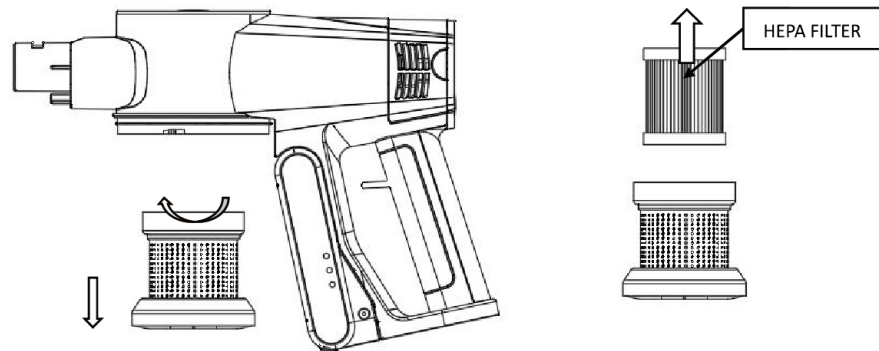

Step 4: The end of the filter element is HEPA, and the filter element can be directly cleaned with water.

Step 5: When the parts are fully dry, install them following the steps.

Tip: It is recommended to carry out the above cleaning after dust removal.

10

#### Warning

1. Cut off the power supply before removing the battery.
2. Do not use and store batteries at temperatures below 5℃ or above 40℃.
3. When disposing of this product, remove the battery from the device.
4. Do not modify the device, accessories or replace the power cord or battery.
5. Battery model: BHDC-L02 22.2V

#### Battery recycling:

Waste batteries are important resources. When disposing of the product, do not dispose of the battery responsibly. Please treat properly in accordance with government regulations to facilitate the recovery to the corresponding waste battery recycling facilities.

#### Wall Mount

Installation diagram: Fixing on the wall

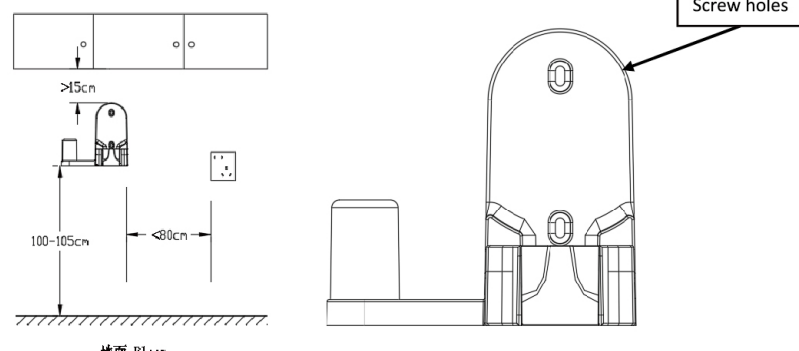

Tips: When installing the docking station, 4\*30mm screw is suggested to be used on the wooden surface. the 6\*30mm expansion pin and 4\*30mm screw should be used on the cement surface.

7

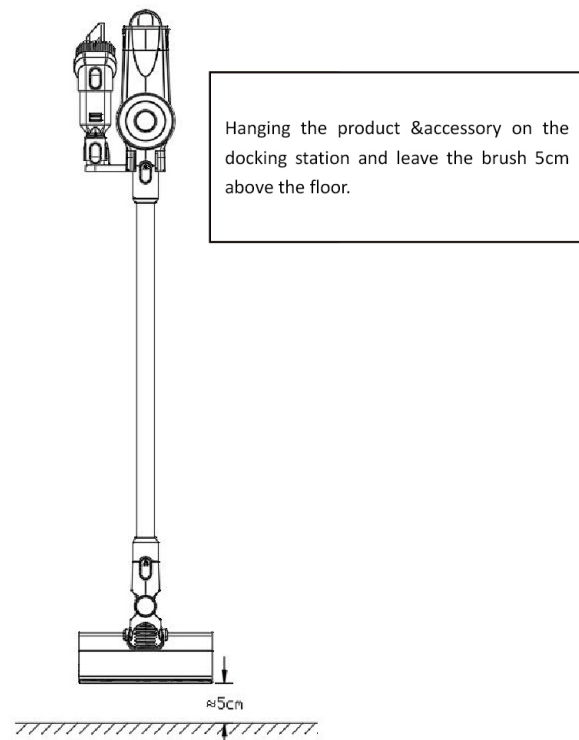

#### Attention

##### Before installation

1. Do not install on weak structures such as plaster walls and compressed wood boards when their thickness is less than 10 mm.
2. To prevent fire or electric shock due to leakage, please do not install it on metal walls.
3. Hanging area must be flat.
4. Wall holder must be placed in ambient temperature between 5℃ and 40℃.
5. Ensure screw will not damage gas pipe, water pipe or wire inside of the wall.
6. No part of the appliance should touch the ground when, placed on the docking station.

8

#### Before use

Disconnect the appliance from the power supply before removing it from the docking station

#### When storing the appliance

1. Please do not apply undue force to the docking station.
2. Do not leave it lean against the wall, always store on the docking station.
3. Must be connected with extension tube and brush.
4. The crevice nozzle must be removed from the extension hose prior to storage.
5. Ensure that brush and extension tube area is clear.
6. Ensure that the wall holder is firmly secured to the wall, check regularly and tighten the screws if necessary.

#### Product Maintenance

##### Dust cleaning

To maintain the suction power of the vacuum cleaner, please clean the dust compartment regularly.

Step 1: Press the button to open the bottom cover of the dust cup and pour out the dust.

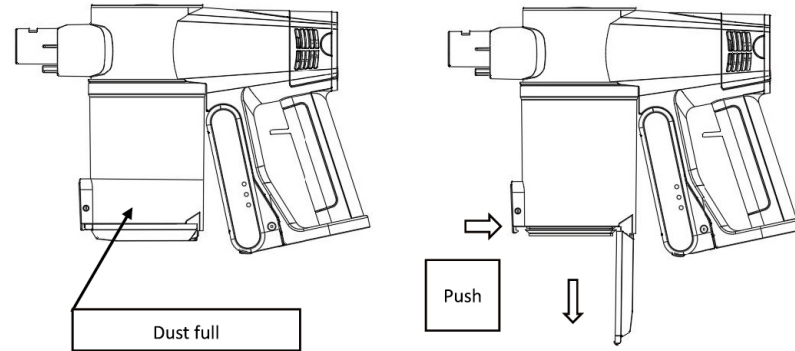

Step 2: Rotate left to remove dust cup and clean dust cup and bottom cover.

9