

# PIFCO®



## INSTRUCTION MANUAL

---

### Upright Vacuum Cleaner

Model number: PUV011

# PIFCO®

## How can we help?

The PIFCO team is always interested in what you have to say, so why not get in touch?



### Call us

01909 544 570



### Email us

info@pifco.com



### Write to us

PIFCO Team, Sabichi Homewares Ltd,  
Priorswell Road, Worksop, SB0 2BY



### Website

www.pifco.com

## Components



# PIFCO®

### **AUTOMATIC THERMAL CUT OUT**

A safety thermostat inside the cleaner protects the motor from overheating if the airways or filters are clogged. If the upright vac suddenly stops working during operation, switch off and unplug immediately. Allow the motor to cool for an hour, empty the dust canister and thoroughly clean the filters and airways. Plug in the vacuum again and switch on. The vacuum should now operate normally.

This is a vacuum cleaner for general purpose, of which measurement and calculation methods used comply with EN60312-1 & EU regulation No. 666/2013

## **What's in the box**

- Upright main body
- Hose
- 3-in-1 multi tool
- Handle
- User guide
- Spare drive belt

## **Safety instructions**

When using an electrical appliance, basic safety precautions should always be followed, including the following:

- Don't use the upright vac for anything other than its intended use. The appliance is not suitable for commercial use. This appliance is only for household domestic indoor use and car cleaning.
- Do not use if the upright vac, cord or plug is damaged.
- Remove all packaging prior to use. Inspect the product for any damage before use.
- Before connecting the upright vac to the power, check the voltage shown on the appliance corresponds with the voltage in your home.
- Keep the upright vac away from heat sources or direct sunlight.
- **WARNING:** Keep the appliance dry.
- To avoid electric shock or injury, never immerse the upright vac body, cord or plug in liquid or water.
- Do not handle the appliance with wet hands.
- Keep away from harsh or abrasive cleaning agents or solvents.
- Ensure you assemble the upright vac correctly before use.
- Do not use attachments not recommended by the manufacturer.
- Always disconnect the appliance from the power supply before assembling, disassembling or cleaning.
- This appliance can be used by children aged from 8 years and above and persons with reduced physical, sensory or mental capabilities or lack of experience and knowledge if they have been given supervision or instruction concerning use of the appliance in a safe way and understand the hazards involved. Children shall not play with the appliance.
- Cleaning and user maintenance shall not be made by children without supervision.
- Only carry the upright vac by the carry handle.
- Do not use the upright vac if it has been dropped, damaged, left outdoors or dropped into water.

- Do not pull or carry by the cord, use the cord as a handle, close a door on the cord, pull the cord around sharp corners or edges, or expose the cord to heated surfaces.
- Ensure fingers and objects are never placed in any part of the vacuum cleaner. Clothing or hair may become trapped in the vacuum if used improperly.
- Keep hair, loose clothing, jewellery, fingers, feet and all parts of your body away from openings and moving parts.
- Keep all air vents clear and free of dust, lint, hair and anything else that may reduce air flow.
- Avoid directing the upright vac near naked flames as the air discharged may extinguish gas fires and pilot lights or disturb ashes in an open fire.
- Do not use the upright vac to suck up large objects or objects that are likely to damage the vacuum cleaner.
- Do not attempt to vacuum long hair, string, pieces of cloth etc., as these may clog the vacuum cleaner.
- Do not vacuum hot items e.g. cigarettes, matches, ashes.
- Do not vacuum fine dust, such as brick dust, plaster dust etc. This may damage the vacuum cleaner.
- Do not vacuum hard or metal objects, nails, pins etc.
- Do not pick up toxic or flammable materials or use in the presence of explosive or toxic dust, liquids or vapour.
- Do not put objects into openings.
- Use only on dry indoor surfaces.
- Never use to suck up water or liquids.
- Do not use without all the filters in place or with any filter blocked.
- Do not use the upright vac to clean animals.
- Switch the cleaner off before plugging or unplugging the vacuum cleaner into the mains supply, and when attaching or removing accessories.
- Take extra care when vacuuming stairs.
- Keep any attachments away from your face and body.
- This vacuum has a thermal safety device which cuts off the power

when overheated. If this happens, unplug the vacuum and allow it to cool down completely before reusing.

- Wrap the cord loosely on the cable hook behind the main body before storing.
- The appliance shall not be left unattended while it is connected to the supply mains.
- Environmental information: If at anytime in the future you should need to dispose of this product, please note that, in the UK, waste electrical products/batteries should not be disposed of with household waste.
- Some delicate rugs and floor surfaces are not suitable to be cleaned with an upright vacuum cleaner with a rotating brush. For example, some loop pile carpets, loose lightweight rugs, and deep pile carpets or rugs with long fibres. Do not place or use the vacuum on these surfaces.

# Assembly instructions

Before assembling or disassembling attachments, ensure the upright vac is not plugged into the mains supply and is switched off.

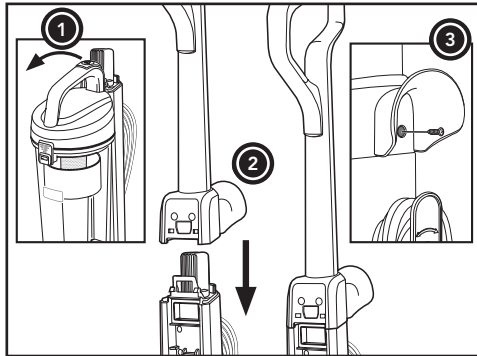

Remove the dust canister before installing handle. Push the handle onto the vacuum body, and use a Phillips screwdriver to secure it with the screw provided.

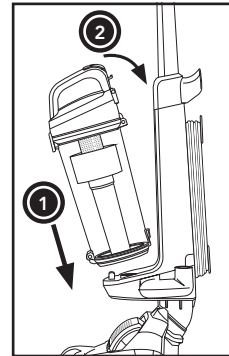

Place the dust canister back onto the machine and push until it clicks into place.

**IMPORTANT:** The handle must be inserted first before replacing dust canister.

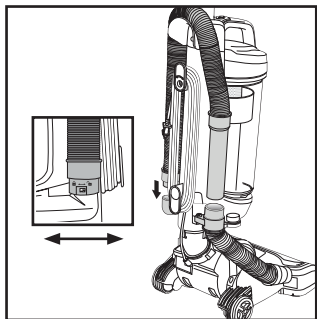

Place the short hose end onto the connector (left hand side if looking at the back of the vacuum), and rotate clockwise to lock.

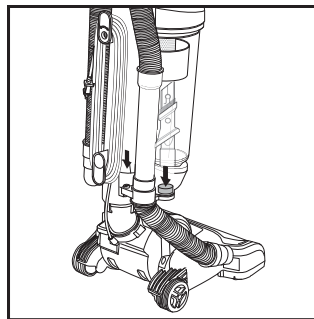

Push the hose handle into the connector, and place the 3-in-1 attachment onto the storage holder in front of the hose handle.

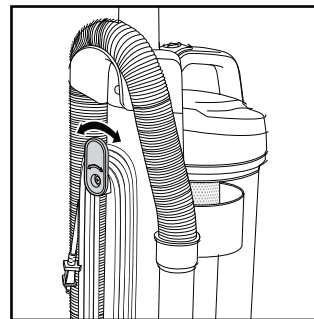

Twist the quick release cord hook to release the power cord.

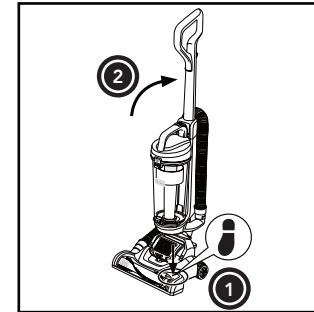

Step on the brush cover and pull back on handle, to engage for operation.

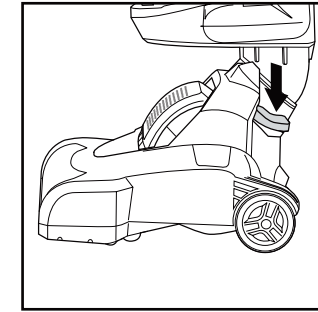

Plug in your machine and push ON/OFF button to switch ON/OFF.

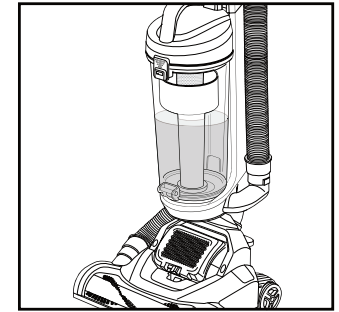

To maintain optimal performance, please empty dust canister when debris reaches MAX FILL line.

## Using the attachments

When changing the attachments ensure the upright vac is switched off.

### 3-IN-1 CREVICE TOOL ACCESSORY

- The 3-in-1 crevice tool with brush allows for vacuuming in narrow and hard-to-reach places.
- Push the locking tab in to remove the brush accessory.
- Use the soft bristles for dusting surfaces, and reverse the attachment to use as an upholstery tool.
- Remove the hose handle from the machine. Always ensure the vacuum is in upright (parked position) when using the hose.
- The rotating brush is lifted clear of the floor surface while the vacuum is parked upright. To prevent possible flooring damage, do not tilt the vacuum forwards or sideways while using the hose.
- For stairs, position the cleaner with the rear wheels against the stair tread (vacuum cleaner facing away from the stairs), and use the attachments to clean each step.

The hose is ready to use alone, or fit the 3-in-1 crevice tool to suit the cleaning task.

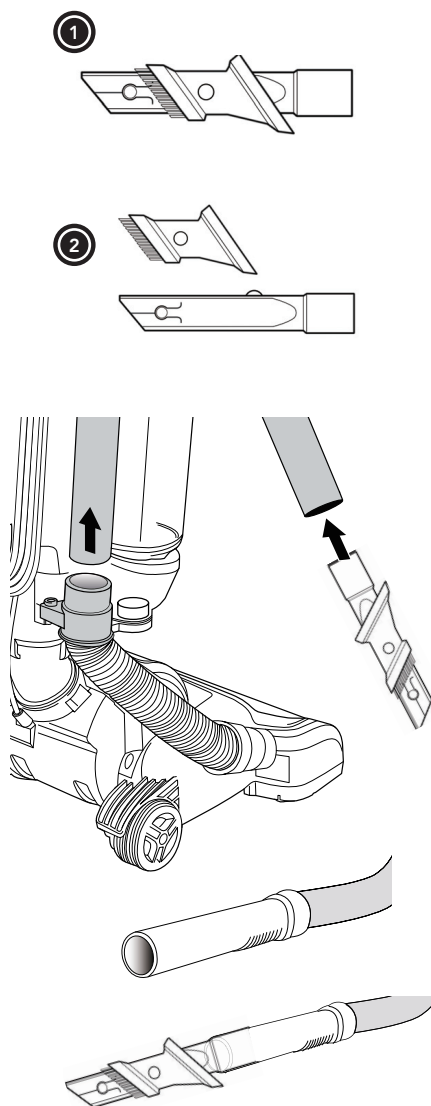

## Removing & emptying the dust canister

Ensure the vac is switched off before emptying the dust canister.

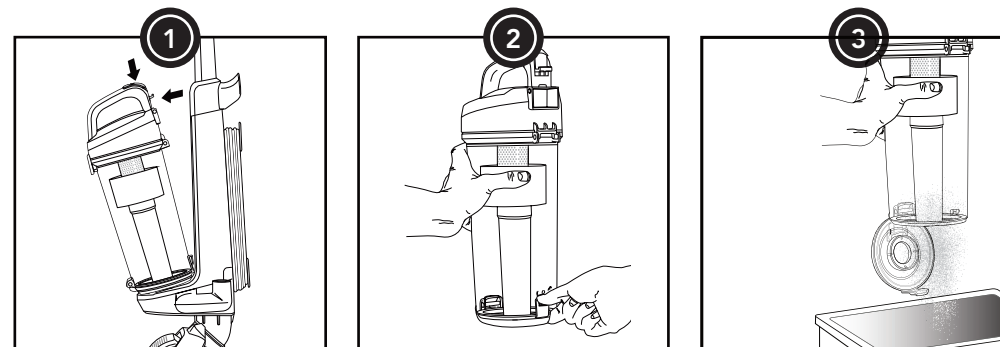

Press dust canister release button to remove the dust canister.

Hold dust canister over rubbish bin and unclip the lock on the bottom of the canister, allowing the dust to empty.

Close the base of the dust canister, align the canister base back onto the machine and push until it clicks back into place.

**WARNING:** If the filter or hose is clogged, the motor may shut down in order to protect itself from overheating. If this occurs, unplug the vacuum, clean the filter and inspect the hoses and canister for clogging. Allow 1 hour for the unit to fully cool down before resuming use.

## Checking for blockages

- Inspect the lower tube and nozzle and remove any dirt and debris.
- The lower hose can be removed from the nozzle.
- Remove the main hose by rotating the connector to unlock, and check for blockages in the hose and elbow connector.
- Remove the dust canister, and follow the steps on the next page for cleaning.

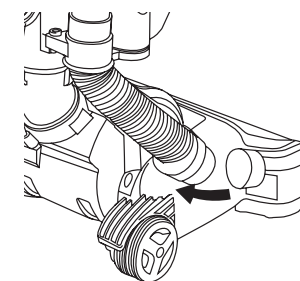

**PIFCO®**

**PIFCO®**

# Cleaning the filters

Before starting any cleaning, ensure the upright vac is not plugged into the mains supply and is switched off.

Wash with water every month, allow at least 24 hours to dry and make sure it is dry thoroughly before re-using.

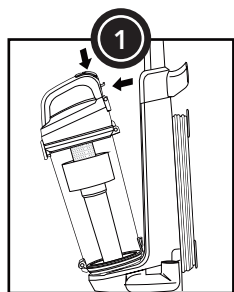

Remove the dust canister.

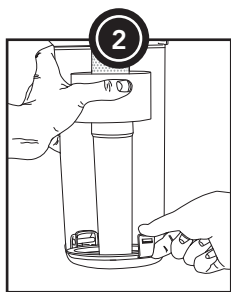

Push the release button, open the dust canister and clean all parts of the dust canister.



Open the dust canister filter lid located on top of the canister.

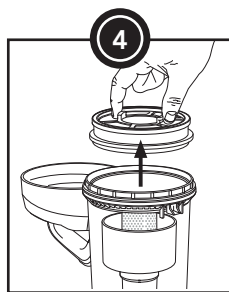

Remove the dust canister foam and HEPA filter. Shake and tap the foam and HEPA filter over a bin to remove excess dust.

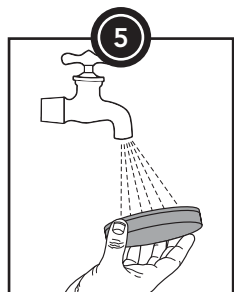

Use cold running water (no detergents) to wash both parts of the filter.



Allow filter to dry for 24 hours before putting back into vacuum cleaner.

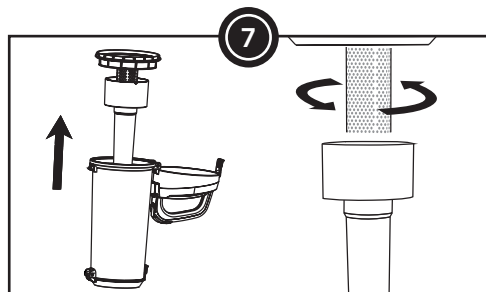

Lift out the assembly from transparent dust canister and then untwist filter from the central tube to remove for cleaning dirt and debris as needed. Follow steps in reverse to reassemble.

**Do not** operate without filter installed  
**Do not** wash dust canister in the dishwasher  
**Do not** install filter if it is damp

**CAUTION:** Do not turn the appliance on when the dust canister is removed. In order to keep the suction force optimised, the dust canister and filters must be cleaned regularly.

**WARNING:** Turn off and unplug vacuum cleaner before performing maintenance to the vacuum cleaner.

## CLEANING BRUSH ROLL

Carefully remove any string, hair or debris located on the brush roll. You can use a tool such as a small knife or scissors to remove and cut any hair or string.

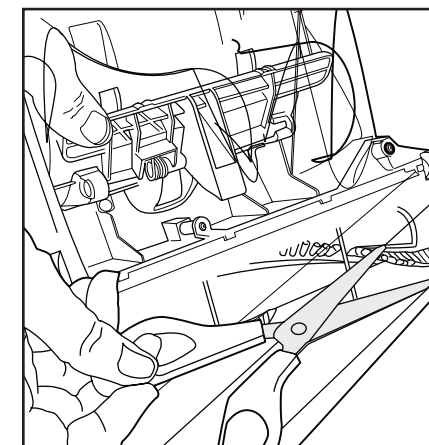

**PIFCO®**

**PIFCO®**



## Maintenance

- Do not clean the vacuum cleaner, components or accessories using petrol or any other flammable liquid or solvents, etc.
- Clean only the outside of the vacuum cleaner.
- Use only a moist cloth and mild detergent for cleaning the vacuum cleaner, components and accessories.
- After cleaning, wipe off the moisture on vacuum cleaner, components and accessories with a dry cloth.
- Do not place accessories, tools or components in a dishwasher.

### BRUSH ROLL

You should check your cleaner's brush roll and drive belt regularly for wear or damage. You should also clean the brush and brush ends by removing string, hair and carpet fibres. These can wrap around the brush and hamper its ability to effectively clean your carpet. Also remove any debris that has accumulated under the brush cover.

Turn off vacuum, unplug from electrical outlet and lace vacuum upside down.

- 1 Remove the six screws as shown with a small Phillips screwdriver.
  - 2 Lift off brush cover. It will unclip the securing lug on the front of the housing.
  - 3 Grasp floor brush at both ends and remove by lifting out.
  - 4 Clean string, hair and other debris from floor brush, motor pulley, and drive belt. Check air passageway for obstructions. Remove debris from this area.
  - 5 When finished cleaning, reposition floor brush and drive belt. Turn floor brush by hand several times in the direction of the motor pulley. If properly installed, the drive belt will align itself on floor brush.
- Then replace the brush cover and re-install the six screws.

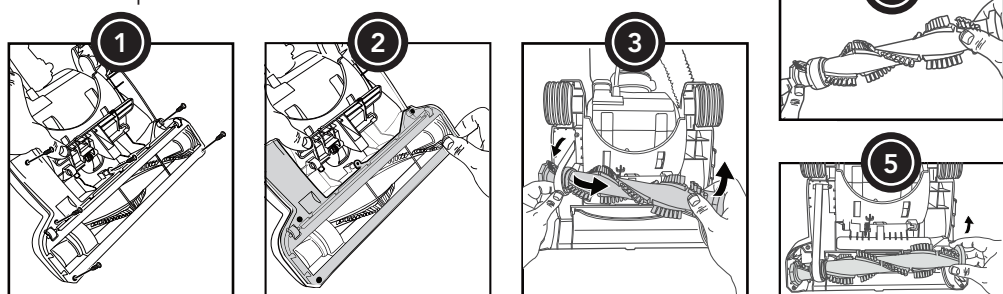

**PIFCO®**

## Replacing The Drive Belt

**For your convenience we have included an extra drive belt with this vacuum.**

Make sure the vacuum is switched off and unplugged first.

Check the drive belt carefully for wear, cuts and stressed areas. If the drive belt appears worn, you will need to replace it. To remove the drive belt, read the instructions and follow the drawings below:

- 1 Grasp the old drive belt and remove from motor shaft. Discard old drive belt.
- 2 Loop new drive belt over motor shaft and stretch other end over floor brush in the space provided between the bristles.
- 3 Place ends of floor brush down into slots on sides as shown. Turn floor brush by hand several times in the direction of the motor shaft. If properly installed, drive belt will align itself on floor brush.
- 4 Replace brush cover and six screws.

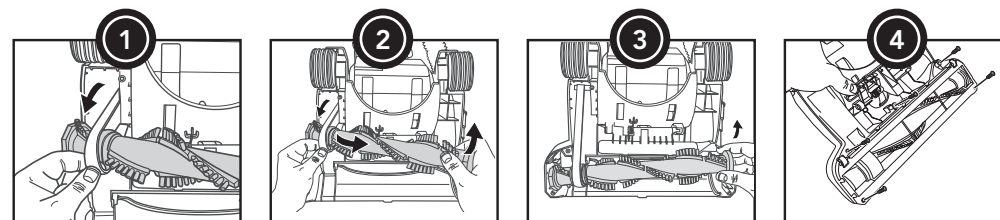

**PIFCO®**



# Changing the fuse

- 1 Only use a 13 amp fuse.
- 2 To change the fuse, place a screwdriver into the recess of the plug cover and pull the fuse holder upward until it's free.
- 3 Slide the fuse out and pop in the replacement.
- 4 Slot the fuse holder back into the recess and push down until it locks into place.

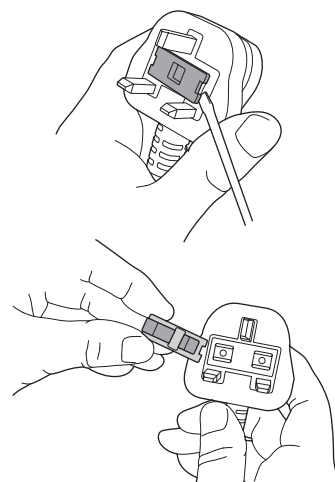

# Spares

Accessories and Spare parts for your vacuum can be found at [www.pifco.com](http://www.pifco.com)

# Troubleshooting

Problem	Solution
Low suction power	<ul style="list-style-type: none"><li>1 Empty the dust canister and clean the filters.</li><li>2 Check for blockages in the airpath: nozzle hose and connector, main hose, and the elbow connector between the hose and dust canister.</li><li>3 Remove any hair/threads from the brush roll, and check it is rotating correctly.</li></ul>
Vacuum is difficult to push on certain carpets	There is a flexible sealing strip on the floor head behind the brush roll opening. Pinch one end to lift it slightly, and slide out of the floor head sideways from one end to remove. This will make the cleaner easier to push over plush carpet.
Vacuum cleaner switches off during use	The thermal cut out has activated as the airflow is restricted. Unplug the vacuum, empty the dust canister, clean filters and check for blockages. Allow the motor to cool for 1 hour before resuming use.
Strange sound/smell	Switch off and unplug. Check that nothing has become caught in the brush roll in the floor head. If the brush roll is jammed by an object or built up of hair or debris, this may damage the belt. Remove the cover and inspect the belt; replace if needed.

## Technical details

**Model:** PUV011

**Dimensions:** H106cm x W31cm x D30cm

**Power:** 400W

**Voltage:** 220-240v ~ 50-60Hz

**Sound level:** 80dBA

**Weight:** 4.5KG

**Country of origin:** China



Sabichi Homewares Ltd  
5 Wadsworth Road, Perivale, Middlesex UB6 7JD  
20 Harcourt Street, Dublin D02 H364



### WASTE ELECTRICAL RECYCLING:

This symbol indicates the product is classed as Electrical or Electronic Equipment and should not be disposed of with other household waste.

The Waste Electrical and Electronic (WEEE) Directive has been introduced across the EU:

- To recycle waste electrical products using the best available recovery and recycling techniques.
- To minimise the impact to on the environment
  - To treat any hazardous substances
  - To avoid increasing landfill

WEEE product should be disposed of by handing it over at a designated collection point. For more information about where to drop off your waste product for recycling please contact you local authority.

## Warranty

This product is guaranteed for 1 year from the date of original purchase. If the product fails within this period due to faulty materials or workmanship, it will be repaired, replaced or refunded at our discretion.

Proof of purchase will be required.

### This warranty applies only to:

- Product installed and used in accordance with the instructions contained in this manual.
- Product used for domestic purposes only.
- Product purchased in the UK and Ireland.

### This warranty does not cover:

- Cosmetic damage.
- Normal wear and tear or consumable parts.
- Incorrect voltage supply or power surges.
- Customer misuse, modifications or adjustments.
- Products with unreadable or removed serial numbers.

### PIFCO disclaims any liability for incidental or consequential loss or damages.

#### In the event of a problem:

- Please refer to the troubleshooting tips section within your user guide for help and guidance.
- If you are still unable to resolve the problem, please contact our technical support team for assistance.

#### When contacting PIFCO please provide:

- Product model number and serial number. Model & serial numbers can be found on the product rating label.
- Date of purchase.
- Complete description of the problem.

This information will help our team assist you more quickly.

Help Line: 01909 544 570

Opening Hours: Monday - Friday 9am – 5pm

Email: [info@pifco.com](mailto:info@pifco.com)

**PIFCO®**

**PIFCO®**

**PIFCO<sup>®</sup>**

**[www.pifco.com](http://www.pifco.com)**