

NINJA®

QB3001UKS

INSTRUCTIONS

SMOOTHIE MAKER



ninjakitchen.co.uk

THANK YOU FOR PURCHASING
your Ninja® Smoothie Maker



REGISTER YOUR PURCHASE

- ninjakitchen.co.uk/register-guarantee/
- Scan QR code using mobile device

RECORD THIS INFORMATION

Model Number: _____

Serial Number: _____

Date of Purchase: _____
(Keep receipt)

Store of Purchase: _____

TECHNICAL SPECIFICATIONS

Voltage: 220-240V~, 50-60Hz
Power: 700 Watts

CUP CAPACITY:
470ml

PLEASE READ CAREFULLY AND
KEEP FOR FUTURE REFERENCE.

CONTENTS

Important Safeguards.....4

Getting to Know Your Ninja Smoothie Maker.....7

Before First Use8

Blending Instructions9

Care & Maintenance.....10

Cleaning 10

Storing..... 10

Resetting the Motor Thermostat..... 10

Troubleshooting Guide.....11

TIP: You can find the model and serial numbers on the QR code label located on the back of the unit by the power cord.

GUARANTEE: This product is unconditionally guaranteed for one year against all defects of workmanship and materials. This guarantee does not affect your statutory rights. If this product proves unsatisfactory please contact our customer service department.

PRODUCT REGISTRATION

Please visit ninjakitchen.co.uk to register your new Ninja® product within 28 days of purchase. You will be asked to provide the store name, date of purchase, and model number along with your name and address.

The registration will enable us to contact you in the unlikely event of a product safety notification. By registering, you acknowledge you have read and understood the instructions for use and warnings set forth in the accompanying instructions.

IMPORTANT SAFEGUARDS

HOUSEHOLD USE ONLY • READ ALL INSTRUCTIONS BEFORE USE

Read all instructions before using your NINJA® SMOOTHIE MAKER

When using electrical appliances, basic safety precautions should always be followed, including the following:

⚠ WARNING

To reduce the risk of fire, electric shock, serious injury, death, or damage when using this appliance, follow these basic safety precautions.

General Precautions

- 1 Read all instructions prior to using the appliance and its accessories.
- 2 Carefully observe and follow all warnings and instructions. This unit contains electrical connections and moving parts that potentially present risk to the user.
- 3 **ALWAYS** exercise care when handling the Pro Extractor Blades® Assembly. The blades are sharp. **ONLY** grasp the Pro Extractor Blades® Assembly by the outer perimeter of the blade assembly base. Failure to use care when handling the blade assembly will result in a risk of laceration.
- 4 Take your time and exercise care during unpacking and appliance setup. This appliance contains sharp, loose blades that can cause injury if mishandled.
- 5 Take inventory of all contents to ensure you have all parts needed to properly and safely operate your appliance.

- 6 Turn the appliance **OFF**, then unplug the appliance from the socket when not in use, before assembling or disassembling parts, and before cleaning. To unplug, grasp the plug by the body and pull from the socket. **NEVER** unplug by grasping and pulling the flexible cord.
- 7 Before use, wash all parts that may contact food. Follow washing instructions covered in this instruction manual.
- 8 Blades are sharp. Handle carefully.
- 9 To protect against the risk of electric shock, **DO NOT** submerge the appliance or allow the power cord to contact any form of liquid.
- 10 **DO NOT** use this appliance outdoors. It is designed for indoor household use only.
- 11 **DO NOT** operate any appliance with a damaged cord or plug, or after the appliance malfunctions or is dropped or damaged in any manner. This appliance has no user-serviceable parts. If damaged, contact SharkNinja for servicing.
- 12 **DO NOT** abuse the power cord. Never carry the appliance by the power cord or yank it to disconnect from electrical socket; instead grasp the plug and pull to disconnect.
- 13 Extension cords should **NOT** be used with this appliance.

14 DO NOT allow children to operate this appliance, to play with it, or use as a toy. Keep the appliance and its cord out of reach of children.

15 This appliance is **NOT** intended to be used by people (including children) with reduced physical, sensory, or mental capabilities, or lack of experience and knowledge, unless they are given supervision or instruction concerning use of the appliance by a person responsible for their safety.

16 Before each use, inspect blade assemblies for damage. If a blade is bent or damage is suspected, contact SharkNinja to arrange for replacement.

17 DO NOT attempt to sharpen blades.

18 Keep the appliance and its cord out of reach of children.

19 DO NOT allow the unit or the cord to hang over the edges of tables or worktops. The cord may become snagged and pull the appliance off the work surface.

20 DO NOT allow any part of the unit to contact hot surfaces, including stoves and other heating appliances.

21 ALWAYS use the appliance on a dry and level surface.

22 NEVER place a blade assembly on the motor base without it first being attached to its corresponding container (bowl, pitcher, cup) and lid.

23 ONLY use attachments and accessories that are provided with the product or are recommended by SharkNinja. The use of attachments not recommended or sold by SharkNinja may cause fire, electric shock, or injury.

24 The use of attachments, including canning jars, not recommended by the manufacturer may cause a risk of injury to persons.

DO NOT use stainless steel cup accessory model XSKDWSS24 with blender.

25 During operation and handling of the appliance, avoid contact with moving parts.

26 DO NOT operate the appliance with an empty container.

27 DO NOT fill containers past the **MAX FILL** or **MAX LIQUID** lines.

28 DO NOT microwave any containers or accessories provided with the appliance.

29 DO NOT perform grinding operations with the Single-Serve Cup and Pro Extractor Blades® Assembly.

30 Before operation, ensure all utensils are removed from containers. Failure to remove utensils can cause containers to shatter and potentially result in personal injury and property damage.

31 Keep hands, hair, clothing, as well as utensils out of container while processing to reduce the risk of severe injury to persons or damage to the appliance. A scraper may be used but only when the appliance is not running.

SAVE THESE INSTRUCTIONS

IMPORTANT SAFEGUARDS

HOUSEHOLD USE ONLY • READ ALL INSTRUCTIONS BEFORE USE

Read all instructions before using your NINJA® SMOOTHIE MAKER

When using electrical appliances, basic safety precautions should always be followed, including the following:

⚠ WARNING

To reduce the risk of fire, electric shock, serious injury, death, or damage when using this appliance, follow these basic safety precautions.

GENERAL PRECAUTIONS

- 32 NEVER** operate the appliance without lids and caps in place. **DO NOT** attempt to defeat the interlock mechanism. Ensure the container and lid are properly installed before operation.
- 33 DO NOT** expose the containers and accessories to extreme temperature changes. They may experience damage.
- 34 NEVER** leave the appliance unattended while in use.
- 35 DO NOT** blend hot liquids. Doing so may result in pressure buildup and steam exposure that can pose a risk of the user being burned.
- 36 DO NOT** remove the cup from the motor base while the appliance is running.
- 37** Remove the Pro Extractor Blades® Assembly from the Single-Serve Cup upon completion of blending. **DO NOT** store ingredients before or after blending them in the cup with the blade assembly attached. Some foods may contain active ingredients or release gases that will expand if left in a sealed container, resulting in excessive pressure buildup that can pose a risk of injury. For ingredient storage in the cup, use only Spout Lid to cover.

- 38** The maximum wattage rating for this appliance is based on the configuration of the Pro Extractor Blades® Assembly and Single-Serve Cup. Other configurations may draw less power or current.
- 39** Max **ON** time is 1 minute under 900W load. If the appliance overheats, a thermal switch will become activated and shut off the motor. To reset, unplug the appliance and let it cool down for approximately 30 minutes before using again.
- 40 DO NOT** process dry ingredients without adding liquid to the Single-Serve Cup. The Single-Serve Cup is not intended for dry blending.
- 41** To protect against risk of electrical shock, **DO NOT** immerse the motor base in water or other liquid.
- 42 DO NOT** spray the motor base with any liquids. Turn off and unplug the motor base before cleaning.



Indicates to read and review instructions to understand operation and use of product.



Indicates the presence of a hazard that can cause personal injury, death or substantial property damage if the warning included with this symbol is ignored.



For indoor and household use only.

SAVE THESE INSTRUCTIONS

GETTING TO KNOW YOUR NINJA® SMOOTHIE MAKER

MAIN UNIT

- A** 470ml Single Serve Cups (x 2)
- B** Ninja Blade Assembly
- C** Motor Base with Power Cord
- D** Spout Lid (x2)

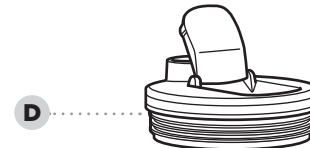
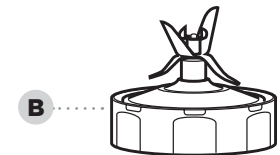
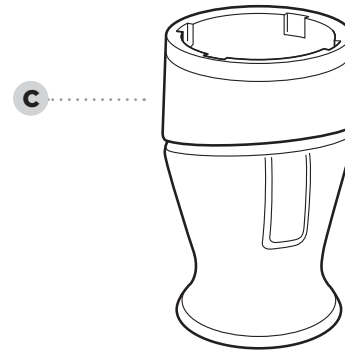

To order additional parts and accessories, visit ninjakitchen.co.uk

BEFORE FIRST USE

DID YOU KNOW?

- You can take your drinks on the go using the Spout Lids.
- The containers, blade assemblies, and lids are BPA free and dishwasher safe.

NOTE: Handle the Pro Extractor Blades® Assembly by grasping around the perimeter of the blade assembly base.

NOTE: All attachments are dishwasher safe. It is recommended that the lids, containers and blade assemblies be placed on the top rack of the dishwasher. Ensure blade assemblies and lids are removed from their containers before placing in the dishwasher. Exercise care when handling blade assemblies.

- 1 Remove all packaging materials from the appliance. Exercise care when unpacking blade assemblies. All blade assemblies are sharp.
- 2 Wash containers, lids, and blade assemblies in warm, soapy, water using a dishwashing utensil with a handle to avoid direct contact with the blades. Exercise care when handling blade assemblies, as the blades are sharp.
- 3 Thoroughly rinse and air-dry all parts.

BLENDING INSTRUCTIONS



- 1 Add ingredients to the Single-Serve Cup. **DO NOT** add ingredients past the **MAX LIQUID** line on the cup.

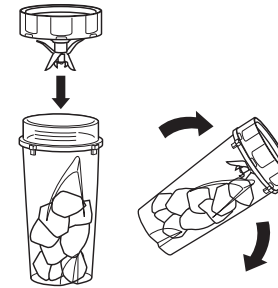

- 2 Place the Blade Assembly on the top of the cup and turn clockwise to seal.
- 3 Turn cup upside down so the bottom of the blade assembly is flat on the worktop.
- 4 Place the cup upside down on the motor base. Press down on the cup to pulse or blend

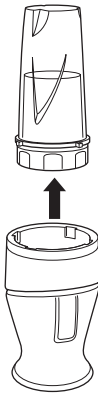
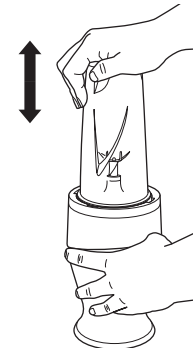

- 5 When blending is complete, lift up the cup to remove

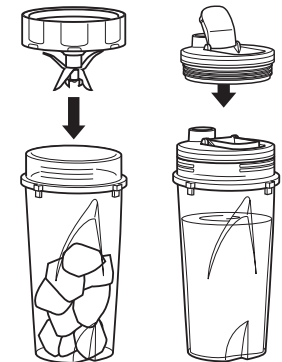

- 6 Turn cup over so blade assembly is on top. Twist blade assembly anti-clockwise to remove. To take your blended contents on the go, place the spout lid on cup and turn clockwise to seal. Do not store with the blades attached.

CARE & MAINTENANCE

CLEANING

- 1 Separate all parts.
- 2 Wash all containers in warm, soapy water with a soft cloth.
- 3 **Hand-Washing**
Wash cups, lids and blade assembly in warm, soapy water. Use a dishwashing utensil with a handle to avoid direct contact with the blades. Exercise care when handling the blade assembly as the blades are sharp. Thoroughly rinse and air-dry all parts.

Dishwasher

Cups, lids, and blade assembly are dishwasher safe. Place the cups, lids, and blade assembly on the top rack of the dishwasher **ONLY**. Ensure the blade assembly and lid are removed from the cup before placing in the dishwasher.

Motor Base

Turn off the unit and unplug the motor base before cleaning. Wipe motor base with a clean, damp cloth.

NEVER directly spray the base with water or other liquids.

DO NOT use abrasive cloths/pads/brushes to clean the base, as this can dull or scratch the surface.

RESETTING THE MOTOR THERMOSTAT

This unit features a unique safety system that prevents damage to the motor and drive system should you inadvertently overload it. If the unit is overloaded, the motor will be temporarily disabled. Should this occur, follow the reset procedure below.

- 1 Unplug the unit from the socket.
- 2 Allow the unit to cool for approximately 30 minutes.
- 3 Remove the container's lid and blade assembly. Empty the container and ensure no ingredients are jamming the blade assemblies.

IMPORTANT: Ensure that maximum capacities are not exceeded. This is the most typical cause of appliance overload.

TROUBLESHOOTING GUIDE

WARNING: To reduce the risk of shock and unintended operation, turn power off and unplug unit before troubleshooting.

Motor doesn't start or blade assembly doesn't rotate

- Make sure the cup is securely placed onto the motor base.
- Check that the plug is securely inserted into the socket.
- Check fuse or breaker in your home. Replace the fuse/reset breaker.
- Check that the inside of the motor base is clean and there is no food blocking the connection between the motor base and the cup.
- There is too much food in the container. Unplug the motor base. Remove some food and try again.
- The unit has overheated. Unplug and wait approximately 15 minutes before using again.

Food collects on the sides of the cup

- Too much food is being processed at one time. Turn the motor base off. When the blades stop rotating, remove the cup from the motor base. Remove some of the food being processed.

Snow from ice cannot be achieved

- Do not use ice that has been sitting out or has started to melt.
- Be sure to use short pulses in the beginning to break up large pieces.

VISIT US ONLINE AT:
ninjakitchen.co.uk

Or follow us on any of our social media pages:



@ninjakitchenuk



This marking indicates that this product should not be disposed with other household wastes throughout the EU. To prevent possible harm to the environment or human health from uncontrolled waste disposal, recycle it responsibly to promote the sustainable reuse of material sources. To return your used device, please use the return and collection systems or contact the retailer where this product was purchased. They can take this product for environmental safe recycling.

Euro-Pro Europe Limited
3150 Century Way, Thorpe Park,
Leeds, LS15 8ZB, UK
ninjakitchen.co.uk

Illustrations may differ from actual product. We are constantly striving to improve our products; therefore the specifications contained herein are subject to change without notice.

NINJA is a registered trademark of SharkNinja Operating LLC.

© 2020 SharkNinja Operating LLC.

QB3001UKS_30_IB_MP_200521_Mv1
PRINTED IN CHINA

