

Rear Speaker

Operating Instructions

SA-Z9R



4-727-591-13(1)
©2018 Sony Corporation Printed in Malaysia

Owner's Record

The model and serial numbers are located on the rear of the Rear Speaker. Record the serial numbers in the space provided below. Refer to them whenever you call upon your Sony dealer regarding this product.

Model No. SA-Z9R _____
Serial No. _____

What You Can Do with the Rear Speakers

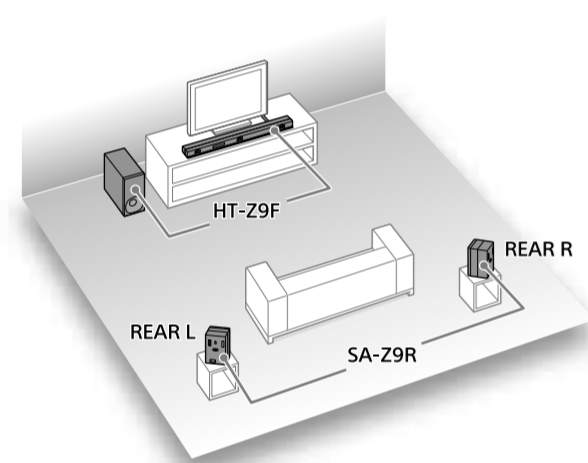

The following are available when the rear speakers are used with the Sound Bar (HT-Z9F) (not supplied).

- You can enjoy the surround sound that makes you feel as if you were actually listening to a live performance.
- You can update the software of the rear speakers. For details, refer to the Operating Instructions supplied with the Sound Bar (HT-Z9F).

Note

- The rear speakers are designed exclusively for use with the Sound Bar (HT-Z9F) and cannot be used with other devices.
- Install the rear speakers vertically.

Parts and Controls

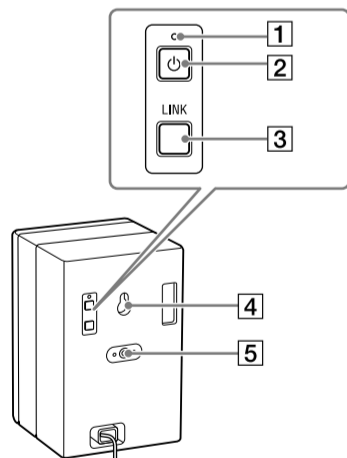

- Power indicator
- ⏻ (power) button
- LINK button
- Wall mount hole
- Mounting hole for the general speaker stand

Power indicator

Indicator status (color)	Rear speaker status
Flashes slowly (green)	The rear speaker is not connected to the Sound Bar (HT-Z9F).
Lights up (green)	The rear speaker is connected to the Sound Bar (HT-Z9F).
Flashes twice repeatedly (green)	The rear speaker is attempting to connect to the Sound Bar (HT-Z9F).
Flashes/lights up (orange)	The software is updating.
Lights up (red)	The rear speaker is in standby mode.
Turns off	The rear speaker is turned off.

Connection

1 Connect the AC power cord (mains lead).

The rear speaker is turned on and connected to the Sound Bar (HT-Z9F) wirelessly.

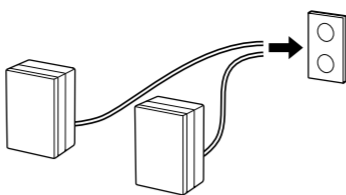

2 Make sure that the power indicator on the rear speaker lights in green.

When the power indicator lights in green, the connection of the rear speaker and the Sound Bar (HT-Z9F) is established. If the connection is not established, connect the rear speaker to the Sound Bar (HT-Z9F) manually. For details, refer to the Operating Instructions supplied with the Sound Bar (HT-Z9F).

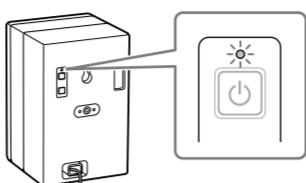

3 Install the rear speaker by considering the right/left of the rear speaker.

Check the label on the rear of the rear speaker. "REAR R" is for the right, "REAR L" is for the left.

Mounting the Rear Speaker on a Wall

You can mount the rear speakers on a wall.

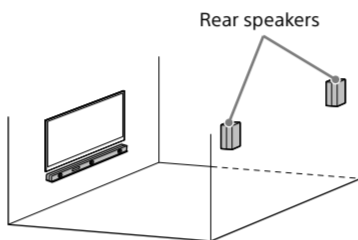

Note

- Prepare screws (not supplied) that are suitable for the wall material and strength. As a plasterboard wall is especially fragile, attach the screws securely in the wall beam. Install the speakers horizontally, hung by screws in studs in a continuous flat section of the wall.
- Have the installation done by a Sony dealer or licensed contractor and pay special attention to safety during the installation.
- Sony shall not be held responsible for accidents or damage caused by improper installation, insufficient wall strength, improper screw installation or natural disaster, etc.

1 Prepare a screw (not supplied) that is suitable for the wall mount hole on the rear of the rear speaker.

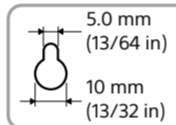
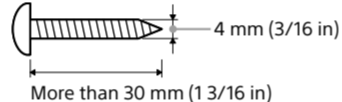

Hole on the rear of the rear speaker

2 Fasten the screw in the wall.

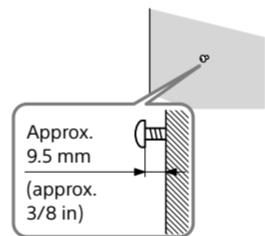

3 Hang the rear speaker by confirming the right/left of the rear speaker.

Check the label on the rear of the rear speaker. "REAR R" is for the right, "REAR L" is for the left.

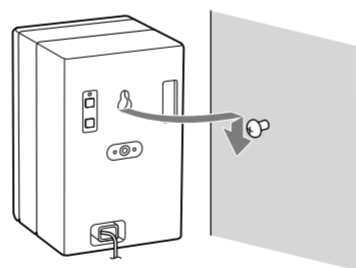

Troubleshooting

If you experience any of the following difficulties while using the rear speakers, use this troubleshooting guide to help remedy the problem before requesting repairs. Should any problem persist, consult your nearest Sony dealer. Be sure to bring all of your rear speakers and Sound Bar (HT-Z9F) (main unit and subwoofer) (not supplied) even if it seems as though only one has a problem, when you request to repair.

No sound is heard from the rear speakers.

- Make sure the AC power cord (mains lead) of the rear speaker is connected properly.
- If the power indicator on the rear speaker does not light, try the following.
 - Make sure the AC power cord (mains lead) of the rear speaker is connected properly.
 - Press ⏻ (power) of the rear speaker to turn on the power.
- If the power indicator on the rear speaker flashes slowly in green or lights in red, try the following.
 - Move the rear speaker to a location near the main unit of the Sound Bar (HT-Z9F) so that the power indicator on the rear speaker lights in green.
 - Connect the rear speaker to the Sound Bar (HT-Z9F) manually. For details, refer to the Operating Instructions supplied with the Sound Bar (HT-Z9F).
 - Check the wireless connection status. For details, refer to the Operating Instructions supplied with the Sound Bar (HT-Z9F).
- Press REAR ↵ + on the remote control of the Sound Bar (HT-Z9F) to increase the volume of the rear speakers.
- If you change the [RF Channel] setting of the Sound Bar (HT-Z9F) from [Off] to [On], it may take 1 minute for the sound to be output. For details, refer to the Operating Instructions supplied with the Sound Bar (HT-Z9F).

Sound skips or has noise.

- If there is a device nearby that generates electromagnetic waves, such as a wireless LAN or a microwave oven in use, locate the rear speakers and the Sound Bar (HT-Z9F) apart from that device.
- If there is an obstacle between the main unit of the Sound Bar (HT-Z9F) and the rear speakers, move or remove the obstacle.
- Locate the main unit of the Sound Bar (HT-Z9F) and the rear speakers as close as possible.
- Switch the network connection of the TV or Blu-ray Disc player from wireless to wired.

Specifications

Amplifier section

U.S. models:

POWER OUTPUT AND TOTAL HARMONIC DISTORTION: (FTC)

With 4 ohms loads, both channels driven, from 20 - 20,000 Hz; rated 20 W per channel minimum RMS power, with no more than 1% total harmonic distortion from 250 mW to rated output.

POWER OUTPUT (reference)

50 W (per channel at 4 ohms, 1 kHz)

Canadian models:

POWER OUTPUT (rated)

30 W + 30 W (at 4 ohms, 1 kHz, 1% THD)

POWER OUTPUT (reference)

50 W (per channel at 4 ohms, 1 kHz)

Speaker system

Full range speaker system, Acoustic suspension

Speaker

46 mm (1 13/16 in) cone type, Full range speaker

Power requirements

120 V AC, 60 Hz

Power consumption

On: 11 W

Standby mode: 1 W or less

Turned off: 0.5 W or less

Dimensions (w/h/d) (approx.)

100 mm × 155 mm × 100 mm (4 in × 6 1/8 in × 4 in) (projecting parts not included)

Mass (approx.)

1.0 kg (2lb 3 3/8 oz)

Wireless transmitter/receiver section

Communication system

Wireless Sound Specification Version 4.0

Frequency band

5 GHz

Modulation method

OFDM

Included items

- Rear speaker R (1), Rear speaker L (1)
- Operating Instructions (1)

On copyrights

This product contains software that is subject to the GNU General Public License ("GPL") or GNU Lesser General Public License ("LGPL"). These establish that customers have the right to acquire, modify, and redistribute the source code of said software in accordance with the terms of the GPL or the LGPL.

For details of the GPL, LGPL and other software licenses, please refer to [Software License Information] under [Setup] - [Advanced Settings] - [System Settings] on the product.

The source code for the software used in this product is subject to the GPL and LGPL, and is available on the Web. To download, please access the following:

URL:

http://oss.sony.net/Products/Linux

Please note that Sony cannot answer or respond to any inquiries regarding the content of this source code.

All other trademarks are trademarks of their respective owners.

WARNING

To reduce the risk of fire or electric shock, do not expose this apparatus to rain or moisture.

The unit is not disconnected from the mains as long as it is connected to the AC outlet, even if the unit itself has been turned off.

To reduce the risk of fire, do not cover the ventilation opening of the appliance with newspapers, tablecloths, curtains, etc. Do not expose the appliance to naked flame sources (for example, lighted candles).

To reduce the risk of fire or electric shock, do not expose this appliance to dripping or splashing, and do not place objects filled with liquids, such as vases, on the appliance.

As the main plug is used to disconnect the unit from the mains, connect the unit to an easily accessible AC outlet.

Should you notice an abnormality in the unit, disconnect the main plug from the AC outlet immediately.

Do not install the appliance in a confined space, such as a bookcase or built-in cabinet.

Indoor use only.

Compliance with FCC requirement 15.407(c) and IC requirement RSS-247

Data transmission is always initiated by software, which is the passed down through the MAC, through the digital and analog baseband, and finally to the RF chip. Several special packets are initiated by the MAC. These are the only ways the digital baseband portion will turn on the RF transmitter, which it then turns off at the end of the packet. Therefore, the transmitter will be on only while one of the aforementioned packets is being transmitted. In other words, this device automatically discontinues transmission in case of either absence of information to transmit or operational failure.

Frequency Tolerance: ±20 ppm or less

For the customers in the U.S.A.

- This symbol is intended to alert the user to the presence of uninsulated "dangerous voltage" within the product's enclosure that may be of sufficient magnitude to constitute a risk of electric shock to persons.

- This symbol is intended to alert the user to the presence of important operating and maintenance (servicing) instructions in the literature accompanying the appliance.

Important Safety Instructions

- Read these instructions.
- Keep these instructions.
- Heed all warnings.
- Follow all instructions.
- Do not use this apparatus near water.
- Clean only with dry cloth.
- Do not block any ventilation openings. Install in accordance with the manufacturer's instructions.
- Do not install near any heat sources such as radiators, heat registers, stoves, or other apparatus (including amplifiers) that produce heat.
- Do not defeat the safety purpose of the polarized or grounding-type plug. A polarized plug has two blades with one wider than the other. A grounding type plug has two blades and a third grounding prong. The wide blade or the third prong are provided for your safety. If the provided plug does not fit into your outlet, consult an electrician for replacement of the obsolete outlet.
- Protect the power cord from being walked on or pinched particularly at plugs, convenience receptacles, and the point where they exit from the apparatus.
- Only use attachments/accessories specified by the manufacturer.
- Use only with the cart, stand, tripod, bracket, or table specified by the manufacturer, or sold with the apparatus. When a cart is used, use caution when moving the cart/apparatus combination to avoid injury from tip-over.



- Unplug this apparatus during lightning storms or when unused for long periods of time.
- Refer all servicing to qualified service personnel. Servicing is required when the apparatus has been damaged in any way, such as power-supply cord or plug is damaged, liquid has been spilled or objects have fallen into the apparatus, the apparatus has been exposed to rain or moisture, does not operate normally, or has been dropped.

NOTE:

This equipment has been tested and found to comply with the limits for a Class B digital device, pursuant to Part 15 of the FCC Rules. These limits are designed to provide reasonable protection against harmful interference in a residential installation. This equipment generates, uses and can radiate radio frequency energy and, if not installed and used in accordance with the instructions, may cause harmful interference to radio communications.

However, there is no guarantee that interference will not occur in a particular installation. If this equipment does cause harmful interference to radio or television reception, which can be determined by turning the equipment off and on, the user is encouraged to try to correct the interference by one or more of the following measures:

- Reorient or relocate the receiving antenna.
- Increase the separation between the equipment and receiver.
- Connect the equipment into an outlet on a circuit different from that to which the receiver is connected.
- Consult the dealer or an experienced radio/TV technician for help.

CAUTION

You are cautioned that any changes or modifications not expressly approved in this manual could void your authority to operate this equipment.

This equipment must not be co-located or operated in conjunction with any other antenna or transmitter.

This equipment complies with FCC radiation exposure limits set forth for an uncontrolled environment and meets the FCC radio frequency (RF) Exposure Guidelines. This equipment should be installed and operated keeping the radiator at least 20cm or more away from person's body.

Frequency Tolerance: ±20 ppm or less

For the customers in Canada

This device complies with Industry Canada's licence-exempt RSSs.

Operation is subject to the following two conditions: (1) This device may not cause interference; and (2) This device must accept any interference, including interference that may cause undesired operation of the device.

This equipment complies with IC radiation exposure limits set forth for an uncontrolled environment and meets RSS-102 of the IC radio frequency (RF) Exposure rules. This equipment should be installed and operated keeping the radiator at least 20cm or more away from person's body.

5.15 - 5.35 GHz band is restricted to indoor operations only.

High-power radars are allocated as primary users (i.e. priority users) of the bands 5250-5350 MHz and 5650-5850 MHz and that these radars could cause interference and/or damage to LE-LAN devices.

CAN ICES-3 B/NMB-3 B