

iQ500, Washing machine, front loader, 10 kg, 1600 rpm  
WM16XM81GB



Wifi-enabled washing machine with Home Connect: Save time with the integrated speedPack and remove the most stubborn 4 stains with stainRemoval system.

- ✓ speedPack XL – Speed up programmes, set the duration or wash in just 15 minutes.
- ✓ Access and control your washing machine, no matter where you are - Home Connect App (Android and iOS)
- ✓ stainRemoval system – removes four types of stubborn stain without pre-treatment.
- ✓ Our new 10kg Washing machines provide more capacity for your individual laundry needs.
- ✓ Outstanding readability and intuitive menu navigation - LED direct touch display

Features

**Technical Data**  
Energy Efficiency Class: .....B  
Weighted energy consumption in kWh per 100 washing cycles of eco 40-60 programme: .....59 kWh  
Maximum capacity in kg: ..... 10.0 kg  
The water consumption of the eco programme in liters per cycle: 47 l  
Duration of eco 40-60 programme in hours and mins at rated capacity: .....3:59 h  
Spin-drying efficiency class of eco 40-60 programme: ..... A  
Airborne acoustical noise emission class: .....A  
Airborne acoustical noise emissions : ..... 72 dB(A) re 1 pW  
Design: ..... Freestanding  
Height of removable worktop: ..... -2 mm  
Dimensions of the product: ..... 848 x 598 x 590 mm  
Weight: ..... 73.8 kg  
Connection Rating: ..... 2300 W  
Fuse protection: .....10 A  
Nominal power: .....220-240 V  
Frequency: .....50-60 Hz  
Length of electrical supply cord: ..... 210.0 cm  
Door opening: .....Left  
Wheels: ..... No  
EAN code: .....4242003908266  
Installation type: ..... Freestanding



4 242003 908266

Optional accessories

WZWP20W	Platform with pull-out, washer, cubic
WX975600	Floor securing component
WZ10131	Extension for cold water inlet /Aquastop

## iQ500, Washing machine, front loader, 10 kg, 1600 rpm WM16XM81GB

### Features

#### Performance

- Energy Efficiency Class<sup>1</sup>: B
- Energy<sup>2</sup> / Water<sup>3</sup>: 59 kWh / 47 litres
- Load capacity: 1 - 10 kg
- Programme duration<sup>4</sup>: 3:59 h:min
- Spin drying efficiency class: A
- Spin speed\*: 400 - 1600 rpm
- Noise level: 72 dB (A) re 1 pW
- Noise efficiency class: A

#### Programmes/functions

- Touch control buttons: less ironing, On/off, Ready in, stain selection, extra rinse, remote start, start/pause with reload function, temperature selection, varioSpeed, prewash, spin speed selection/Rinse Hold
- Standard programmes: cottons, easy care, delicates, wool hand wash
- Special programmes: hygiene, drum clean with reminder, shirts/blouses, Outdoor, drain / spin, PowerWash 59, mixed fabrics, single rinse, rapid 15 minute quick wash

#### Key features

- Home Connect: Remote Monitoring and Control, iService Remote, Energy management
- powerSpeed system: better washing results in less time
- Reload function: Pause the already running washing machine to add any forgotten items of laundry to the drum.
- autoStain removal system (ASR) - 4 stain removal options at the touch of a button
- antiVibration Design - for more stability and quietness
- iQdrive with 10 year warranty

#### Additional features

- Large LCD display for programme status indication, temperature selection, max. spin speed, remaining time and 24 hours end time delay, stain selection and consumption indication
- Drum volume: 70 litres
- drum clean with reminder function
- drum interior light
- waveDrum: for highly effective and extremely gentle laundry care
- waterPerfect Plus: for efficient use of water even with small loads thanks to intelligent sensor technology.
- Detergent dispensing: From front
- Divider for Liquid Detergent
- Sound insulation by additional noise reduction material
- Consumption indicator: Information about water and energy consumption prior to start of programme
- Consump indicator energy+water, autoStain removal system (ASR)
- Aqua Protection
- Jog dial with integrated on/off control
- Foam detection system
- Detergent over dosage display
- Out of balance load adjustment

- Electronic child safety package
- Acoustic signals: Buzzer

#### Technical Information

- Slide-under installation
- Large chrome-black door with 171° opening
- Dimensions (H x W): 84.8 cm x 59.8 cm
- Appliance depth: 59.0 cm
- Appliance depth incl. door: 63.2 cm
- Appliance depth with open door: 106.3 cm

<sup>1</sup> Scale of Energy Efficiency Classes from A to G

<sup>2</sup> Energy consumption in kWh per 100 cycles (in programme Eco 40-60)

<sup>3</sup> Weighted water consumption in litres per cycle (in programme Eco 40-60)

<sup>4</sup> Duration of Eco 40-60 programme

\*\* Values are rounded.

**iQ500, Washing machine, front loader, 10 kg, 1600 rpm  
WM16XM81GB**

## Dimensioned drawings

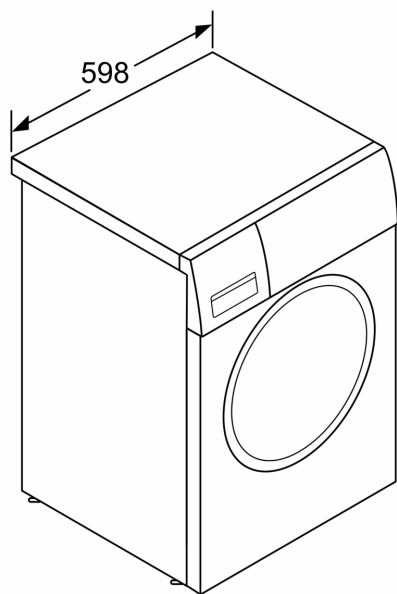

measurements in mm

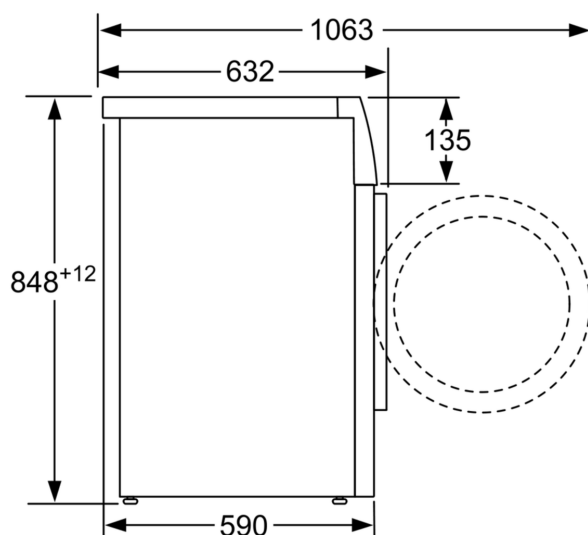

measurements in mm